

Nu-Deck® – 14mm Fastflo® pipe with 22mm structural chipboard and 6mm coverboard

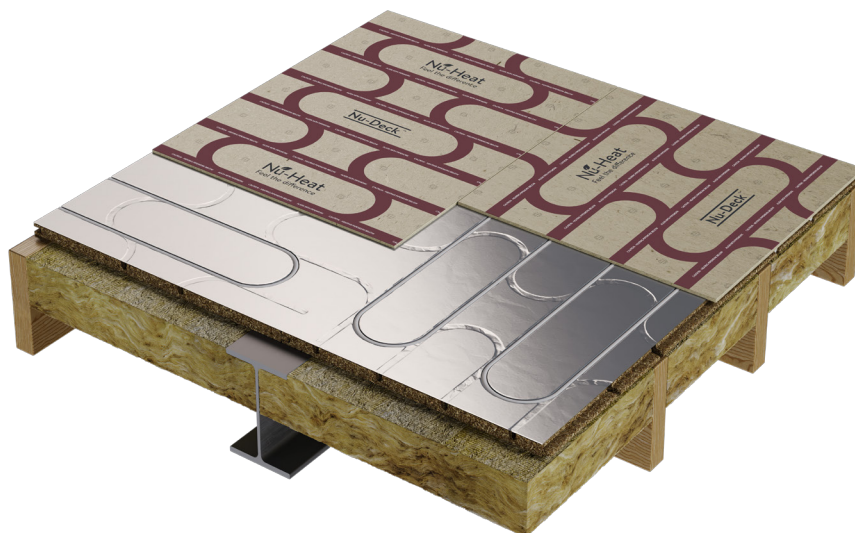

DESCRIPTION

Nu-Deck® is an integrated structural underfloor heating system exclusively for suspended timber floors. Because Nu-Deck® replaces the existing floor deck, there is virtually no additional height build-up compared to traditional floorboards and other floor deck panels.

Designed to meet the complex requirements of modern home construction, Nu-Deck® is suitable for new builds and retrofit/renovation scenarios in either ground floor or multi-storey (first floor, second floor) applications.

Nu-Deck® comprises of 22mm routed P5 chipboard with foil coating, a 14mm underfloor heating pipe, and 6mm moisture-resistant printed MDF cover board with a total thickness of 28mm. Suitable for any suspended timber floor, Nu-Deck can be installed directly to floor joists with a maximum span of 600mm centres.

Nu-Deck's unique design delivers full design and installation flexibility. The bi-directional pre-routed boards can be fitted either side-by-side or at 90° angles to allow for changes in joist direction, whilst still maintaining an uninterrupted route for the pipework for quick and easy fitting.

MAIN FEATURES

- Suspended timber flooring with fully integrated 14mm heat emitter pipework
- Tested and safe to install on joists up to 600mm centres in accordance with BS EN 1195:1998 and BS EN 12871:2013 for Impact, Stiffness and Strength Testing achieving a result of 6.53 kN
- No joints in the pipework under the floor
- 28mm total thickness, replaces standard floorboards or other structural decking
- Only 6mm additional thickness compared to typical standard flooring materials
- Fully foiled boards, improved heat output and also provides some extra protection from water/moisture
- Moisture resistant MDF cover panel, printed with fixing indicators and pipework locations to help prevent accidental fixing through the UFH pipework.
- Complete design and installation flexibility, board and pipe channel designed to allow for changes in joist direction
- Excellent heat output at lower flow temperature, suitable for use with heat pumps
- Completely dry installation, no wet trades or drying times
- Industry standard sheet sizes 2400mm x 600mm, with tongue and groove jointing
- Full design, CAD drawings, heat loss calculations, OEM handover manual and lifetime telephone technical support

Supplied by Nu-Heat

6mm printed MR MDF cover board
 14mm UFH pipe
 22mm chipboard with foil coating

Supplied by others

Insulation (ground floor and
 above unheated spaces)
 Floor joists

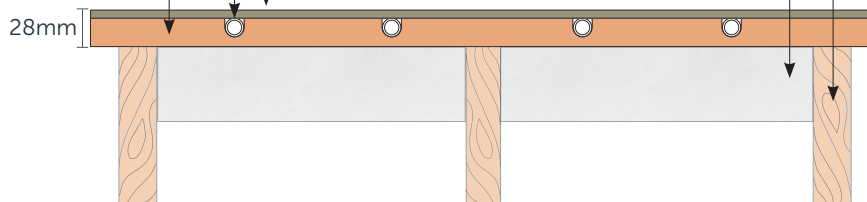
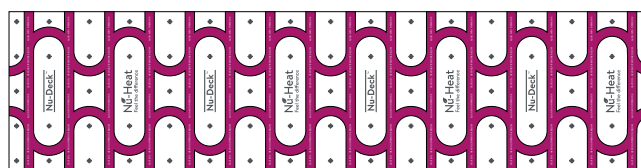
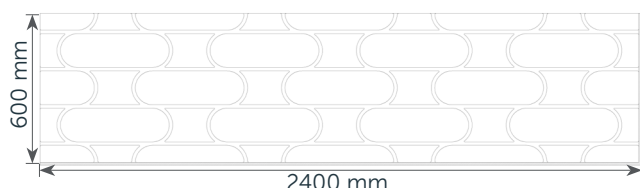
**BOARD & COVER BOARD SUPPLIED:****HEAT OUTPUT***

FLOW WATER TEMPERATURE	AVAILABLE HEAT FLOW W/m ²			
	40 °C	45 °C	50 °C	55 °C
No floor covering - Cover sheet only	54	73	92	112
Carpet	32	44	55	66
2mm Vinyl	45	61	77	93
14mm engineered board + 2mm underlay	35	48	60	73
10mm ceramic tile + DM (inc tile adhesive)	40	54	68	82

*Nominal value; output values vary depending on specific floor finish.

FLOOR HEATING TUBE

Nu-Heat's 14mm Fastflo® tubing is extremely flexible which means that it can easily be installed round the numerous turns typical to any design.

FLOOR COVERINGS

Vinyl floor coverings can be laid directly over the cover board. Additional preparation may be needed depending on the manufacturer's requirements.

When tiling with either ceramic or natural stone tiles, treat as suspended timber chipboard floor, and use suitable primers, decoupling membranes, or tile backer boards as required.

Carpets:

Boilers fed systems - our guidance is a maximum combined tog value of 2.5 tog for the carpet and underlay.

Heat pump fed systems - our guidance is a maximum combined tog value of 1.5 tog for the carpet and underlay.

Engineered timber and laminates can be installed directly on top of the cover board.

Manufacturer guidance should be followed to allow acclimatization of any wood floor products prior to installation.

Note: Floor temperature sensors can be provided by Nu-Heat to allow a cut-off limit temperature to be set where required in line with the floor covering manufacturer's requirements.

INSULATION

Suspended timber ground floors and floors above unheated spaces must be insulated to limit downward heat transmission, this can be achieved with either rigid PIR insulation or mineral wool.

WARRANTIES/INSURANCE

Manufacturer's warranty: all UFH tube supplied by Nu-Heat is covered by a 50-year warranty, the first 10 years of which are insurance-backed.

Product liability: Nu-Heat maintains product liability insurance to £50 million.

Professional indemnity: As Nu-Heat's design service is integral to the operational effectiveness of the UFH system, the company holds professional indemnity insurance of £10 million to cover all aspects of our consultation and design services.

NOTE

Nu-Heat can only give advice on specific details related to the installation of our system components, we are unable to offer any advice or guidance of general plumbing, electrical, carpentry or building practices, acoustic performance, structural design of floor joist arrangement or preparation and application of final floor coverings.

Nu-Deck®