

LoPro®Max14 – 14mm Fastflo in castellated panel with self-levelling compound

Nu-Heat's high performance retrofit underfloor heating solution

Supplied by Nu-Heat

Self-adhesive tanking/expansion strip
LoPro®QuickSet self-levelling compound
14mm Fastflo tubing
Castellated panel

Supplied by others

Concrete slab
Structural floor deck
Joists
Existing/retrofitted insulation (suspended timber floors)
Final floor finish: tiles, stone, carpet, vinyl or engineered timber

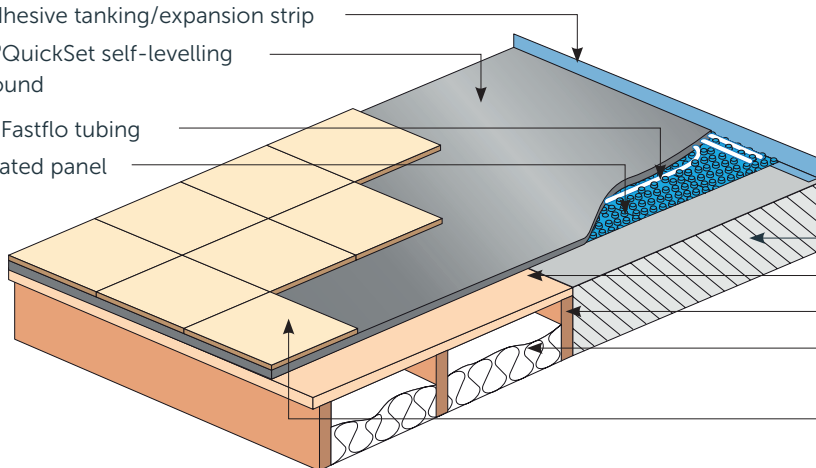

LoPro®Max14 – A WHOLE-HOUSE SOLUTION FOR EXISTING AND NEW-BUILD PROPERTIES, KITCHENS, BATHROOMS, EXTENSIONS, CONSERVATORIES AND PROPERTIES WITH LOW LEVELS OF INSULATION.

- ✓ Outstanding thermal conductivity – heat outputs up to 120W/m²
- ✓ Fast response time – similar to that of a traditional radiator system
- ✓ Direct replacement for a radiator system
- ✓ Provides a perfectly level floor surface ideal for laying tile, stone, vinyl, engineered timber and carpet floor finishes
- ✓ Simple and quick to install
- ✓ Just 26mm height increase over existing floor level (+/-2.5mm)
- ✓ High structural and compressive strength
- ✓ One-third of the running cost of electric UFH
- ✓ Fast drying time – can be walked on after just 8 hours; floor finishes can be fitted after 72 hours

DESCRIPTION

LoPro®Max14 can be laid over new and existing floors. It consists of a castellated panel designed to securely hold 14mm Fastflo® floor heating tube in place which is covered with a specialist self-levelling compound. The castellated panel enables pipe to be conveniently routed back to the manifold or zone distributor and is designed to guide the pipe through 180° bends and to enable multiple runs to be neatly and securely fixed.

LoPro®Max

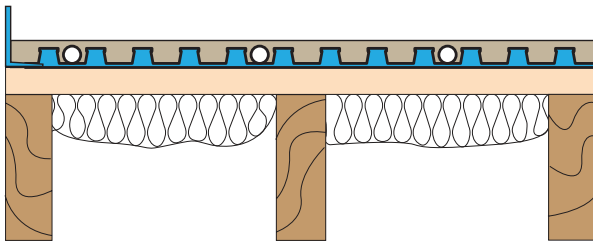

Suspended timber deck with LoPro®Max14

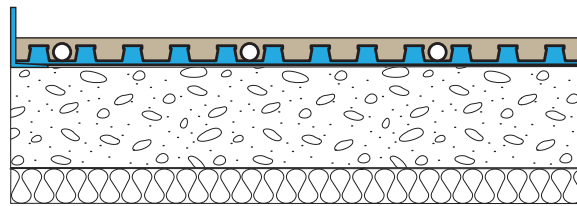

Concrete slab with LoPro®Max14 (insulation may not be present)

LoPro®Max14 can be used over concrete and suspended timber floors

FLOOR HEATING TUBE

Typically, a room or heating zone will use several coils of 14mm Fastflo pipe, providing an even spread of warmth across the floor.

INSULATION

Inclusion of insulation within the floor increases overall system efficiency.

Suspended timber ground floors: In order to limit downward heat transmission, insulation should be installed where practicable; it is often possible to retrofit insulation such as 'space blanket' between joists.

Concrete ground floors: Concrete sub-floors provide a much better thermal barrier to downward heat loss than suspended timber. Therefore, in a retrofit project, there is no economic justification to remove and replace the existing floor unless damp or structural failure are present. The LoPro®Max14 underfloor heating will still perform effectively and efficiently.

Beam & block ground floors: In order to limit downward heat transmission, insulation should be installed where access to the void is practicable. If access is not available, beam and block floors are similar to concrete ground floors in that they provide a much better thermal barrier to downward heat loss than suspended timber. There is insufficient economic benefit to warrant taking them up to fit insulation unless remedial work is being carried out to the floor structure.

UNDERFLOOR HEATING EFFICIENCY

The high thermal efficiency of LoPro®Max14 means warm-up times are similar to those of a radiator system and, because the heat is mainly radiant, air convection currents are minimised and heat loss by natural ventilation is reduced. LoPro®Max14 is a perfect partner for modern gas, oil and LPG condensing boilers.

FLOOR STRUCTURE – RETROFIT & NEW-BUILD

LoPro®Max14 can be installed over concrete and timber floors with ease. Individual castellated panels are laid in brick-bond format and secured to the sub-floor with the self-adhesive backing. Specialist LoPro®QuickSet self-levelling compound is supplied as part of the LoPro®Max14 package.

Where possible existing floors should be levelled prior to fitting LoPro®Max14 but the self-levelling compound supplied will compensate for minor irregularities. For more uneven floor surfaces further bags of LoPro®QuickSet self-levelling compound can be purchased from Nu-Heat.

Virtually any covering (except natural timber) can be applied over LoPro®Max14, but using less thermally resistive coverings ensures greater heat output and faster warm up times.

Note: Avoid applying LoPro®Max14 in direct contact with a bitumen or asphalt floor as the temperature of the system can affect the structural properties of the bitumen/asphalt, consult our team if you need any advice.

WARRANTIES/INSURANCE

Manufacturer's warranty: all UFH tube supplied by Nu-Heat is covered by a 50-year warranty, the first 10 years of which are insurance-backed.

Product liability: Nu-Heat maintains product liability insurance to £5 million.

Professional indemnity: As Nu-Heat's design service is integral to the operational effectiveness of the UFH system, the company holds professional indemnity insurance of £5 million to cover all aspects of our consultation and design services.

For more information and to see a short installation video visit www.nu-heat.co.uk/installLPM

